

L	29.8	41.0	51.9	62.5	73.3	83.9
C	10.0	20.0	30.0	40.0	50.0	60.0
D	10.1	10.9	12.7	12.2	13.7	15.7
E	4.1	5.1	6.7	6.2	7.7	9.7
F	5.6	2.9	2.3	3.0	2.5	2.4

### OPCJA

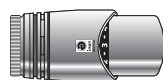

Kod 5090.1111



Kod 5090.1110

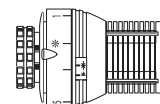

Kod 5090.1119



Kod 5094.425



Kod 5094.427



Kod 5090.1111

### Standard

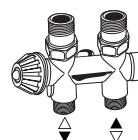
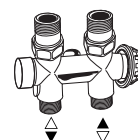

Złącza do instalacji znajdziesz w katalogu Jaga  
[www.jaga.com.pl](http://www.jaga.com.pl)

### UWAGA

Aby zagwarantować moc grzejnika Jaga zaleca stosować rurki o średnicach 16/2, 18/1 of 18/2.

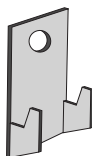

x 4



Ze względów bezpieczeństwa kołki rozporowe nie są dostarczane w komplecie. Dobierz odpowiednie kołki do swojej ściany.

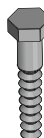

x 4

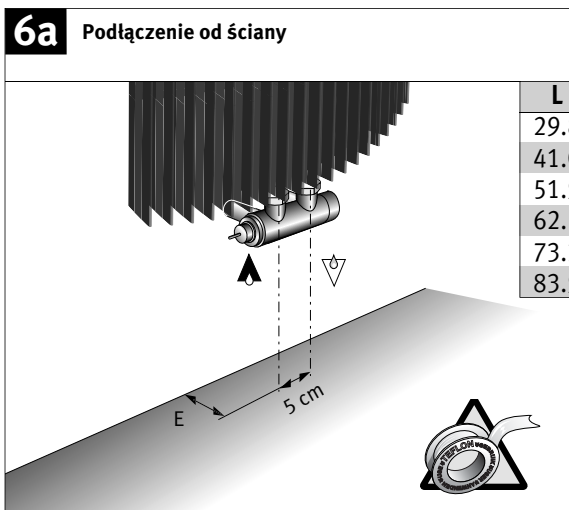
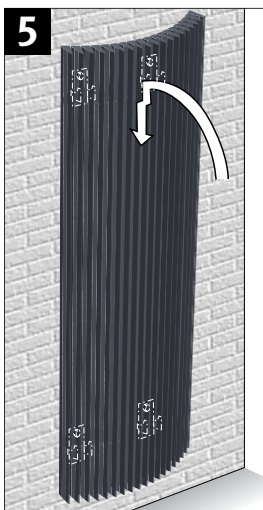
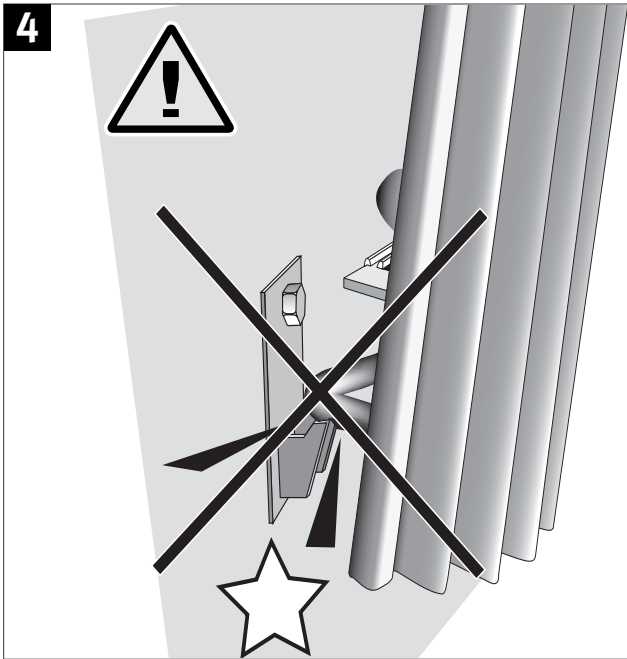
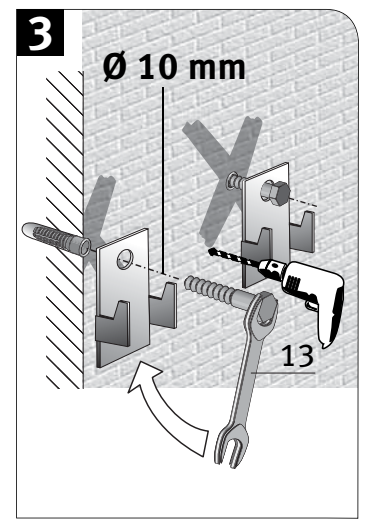
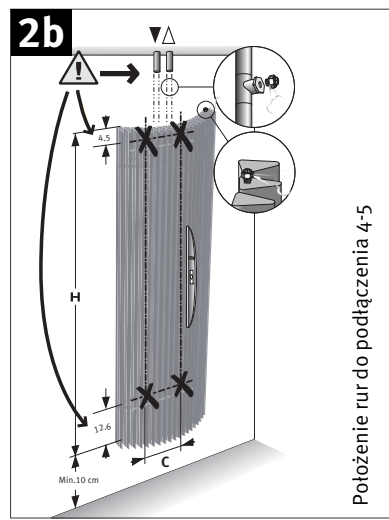
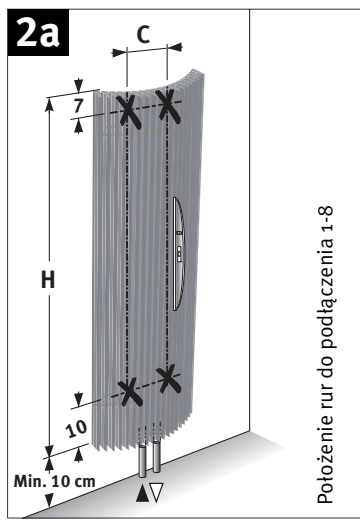
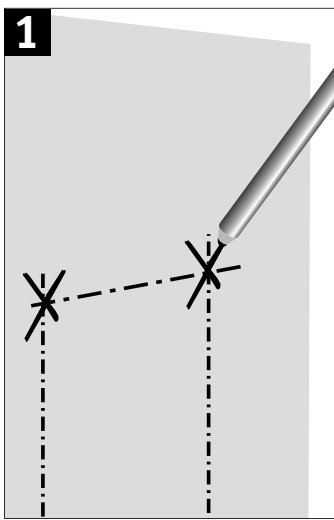

L	E
29.8	4.1
41.0	5.1
51.9	6.7
62.5	6.2
73.3	7.7
83.9	9.7

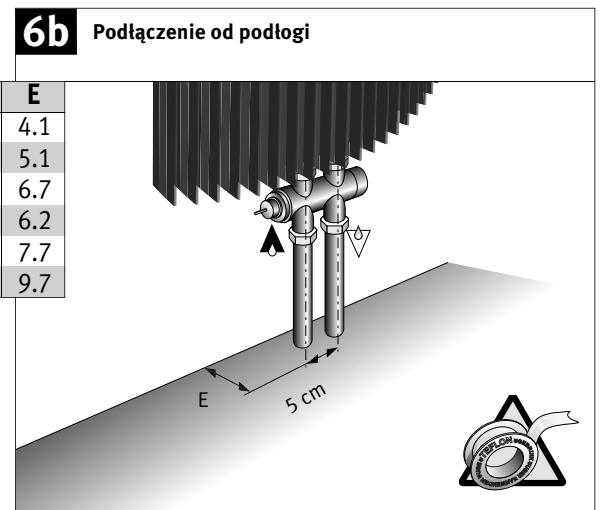

**Podłączenie do instalacji jedno- lub dwururowej**

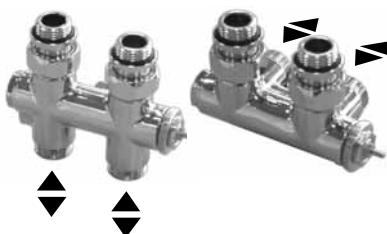

Zasilanie z prawej lub lewej strony, niezależne od pozycji głowicy termostaticznej.

